

## IMPULSE VALVE OPERATOR (IVO) KIT

### DESCRIPTION

The Impulse Valve Operator (IVO) provides means to electrically or manually activate the Fike Impulse Valve clean agent container by providing the force required to extend a piston that will open the rupture disc, allowing the agent to be released from the container.

The IVO can be activated electrically via a signal from Fike control panel or manually by depressing red strike button.

Fike Clean Agent Containers with Impulse Valve **must** use an Impulse Releasing Module (IRM) to supervise the agent release circuit wiring (for open and ground fault conditions) from the container to the control panel. The Impulse Valve Operator Supervisor (IVOS) is used to monitor the presence of the Impulse Valve Operator (IVO). When installed between the Impulse Valve and the IVO, this supervises the presence of the actuation device; when the IVO is removed from the container this will cause a “supervisory event” at the system control panel.

The IVOS can also be used to monitor the presence of the Impulse Valve Pneumatic Operator (IVPO).

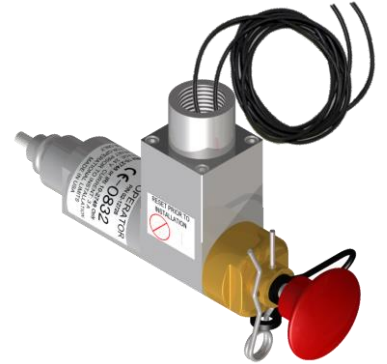

#### APPROVALS:

- FM
- UL
- ULC





## SPECIFICATIONS

IMPULSE VALVE OPERATOR (IVO) KIT (P/N 70-279)		
Item No.	Part Number	Description
1	02-12728	Impulse Valve Operator (IVO)
2	10-2748	Impulse Releasing Module Assembly (IRM)
3	02-14263	Impulse Valve Operator Supervisor (IVOS)
4	02-13130	Safety Cotter Pin
5	02-2213	Security Tie
6	02-12925	Plastic Cap (Black)
Temperature Range		32 to 130°F (0 to 54.4°C)
Listings & Approvals		UL / ULC Listed and FM Approved
SPECIFICATIONS – IMPULSE VALVE OPERATOR (IVO) (P/N 02-12728)		
Normal Supply Voltage		24 VDC
Current Consumption		0 Amps (for Battery Calculation)
Electrical Connection		1/2" NPT for conduit connection
IVO Material		Stainless Steel (Body) / Brass (End Cap)
SPECIFICATIONS – IMPULSE VALVE OPERATOR SUPERVISOR (IVOS) (P/N 02-14263)		
Switch		Normally Closed (Black) / Normally Open (White) / Common (Red)
Conduit		1/4" ID SST Flexible Conduit 33.5" lg. with 1/2" Knockout Connector
Wire Leads		22 AWG, 44" lg.

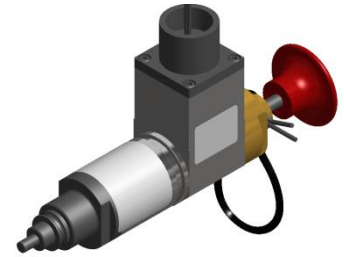

Item No. 1

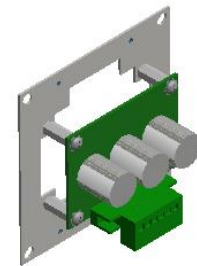

Item No. 2

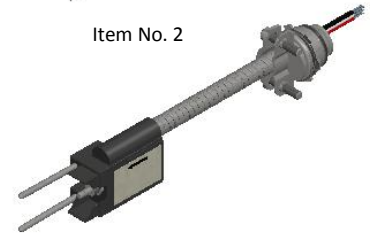

Item No. 3